

1. Performance

1.1 Maximum Rating

Items	Rating	unit
Maximum Working Power	10	dBm
Operating Temperature Range	-40 ~ +85	°C
Storage Temperature Range	-40 ~ +85	°C

1.2 Electronic Characteristics

(at 25°C ±5°C)

	Unit	Minimum	Typical	Maximum
Center Frequency	MHz	-	1588	-
Insertion Loss	dB	1574.42~1576.42 MHz	1.3	1.5
		1559.05~1563.15 MHz	1.8	2.0
		1573.37~1577.47 MHz	1.5	2.0
		1597.78~1605.66 MHz	1.8	2.0
VSWR	dB	1574.42~1576.42 MHz	1.2	2.0
		1559.05~1563.15 MHz	1.6	2.0
		1573.37~1577.47 MHz	1.4	2.0
		1597.78~1605.66 MHz	1.6	2.0
Group delay ripple	ns		5	12
		1597.78~1605.66 MHz		
Attenuation	dB	10~824 MHz	45	50
		824~925 MHz	45	50
		1427~1453 MHz	40	43
		1710~1785 MHz	35	40
		1850~1910 MHz	35	40
		1920~1980 MHz	35	40
		2400~2500 MHz	35	40
		2500~2570 MHz	35	40
		2600~3000 MHz	30	38
4900~5850 MHz	15	24		
Input/Output Impedance	Ohms		50	

1.3 Frequency Characteristics

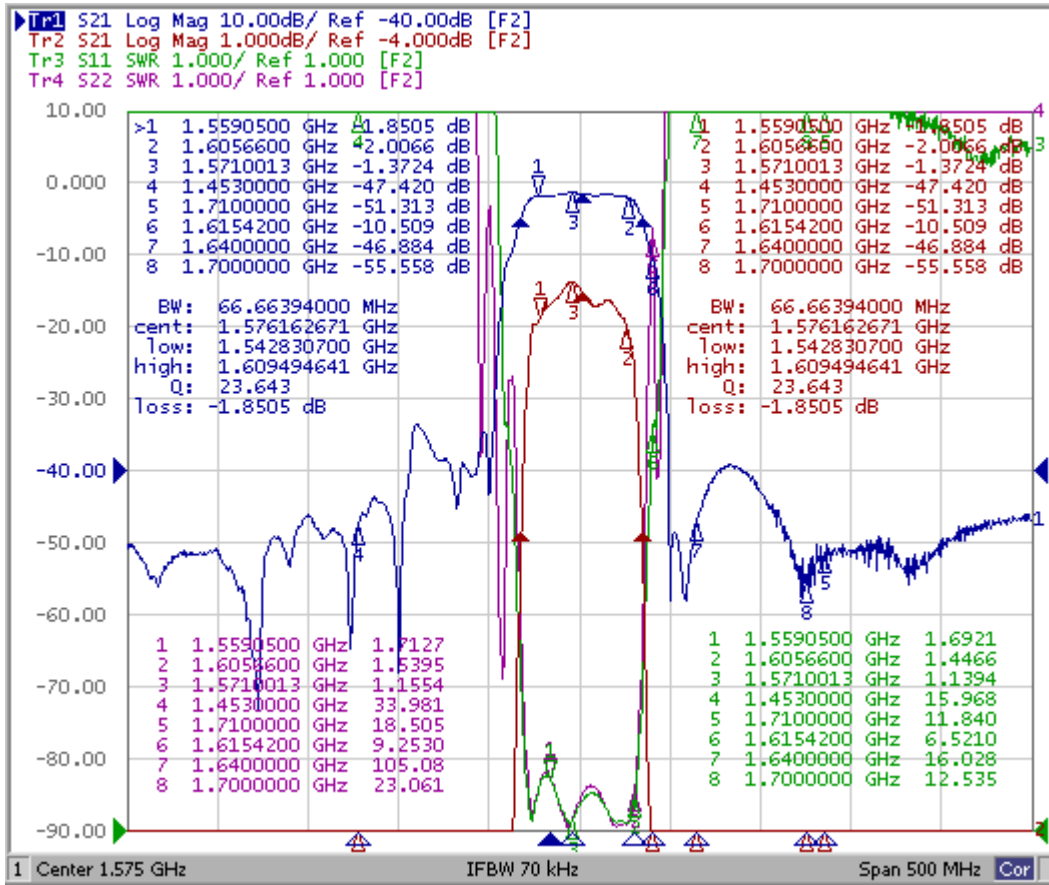

2. Test Circuit

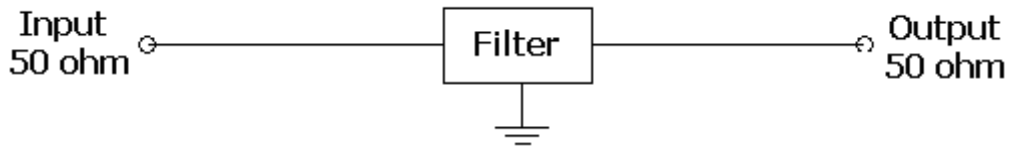

3. Package Dimension

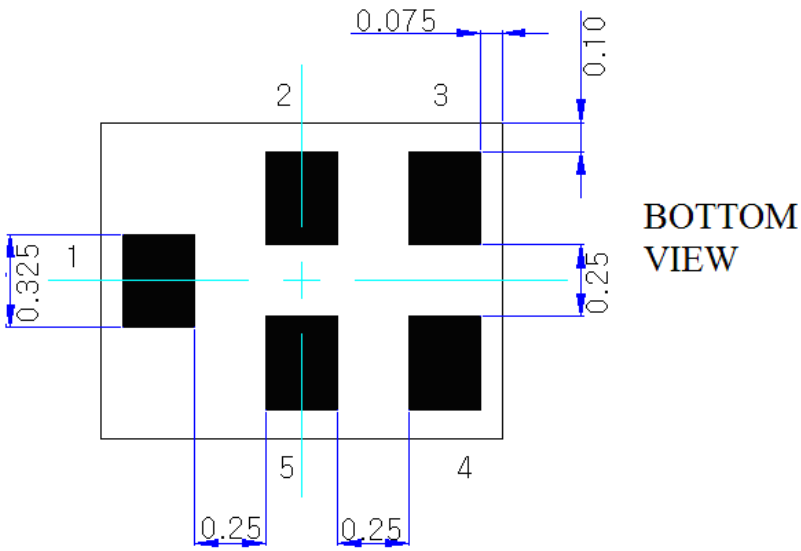
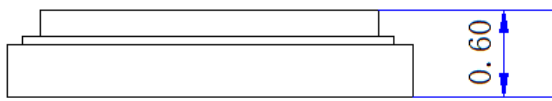
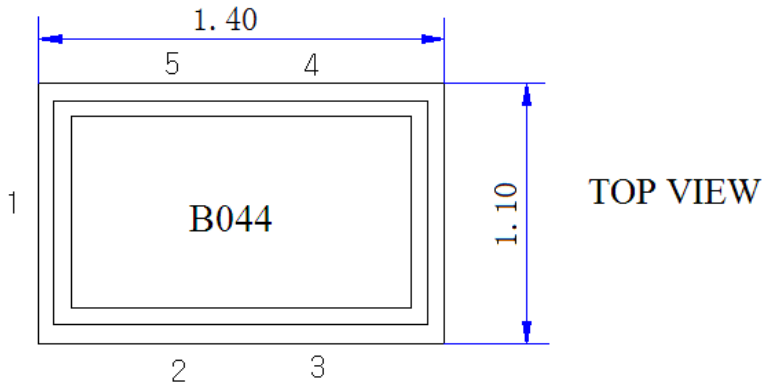

Pin configuration

- 1. Input
- 4. Output
- 2,3,5 To be grounded